

Salads Harvesting Services Ltd

Welcome



G's Intro



Family Business

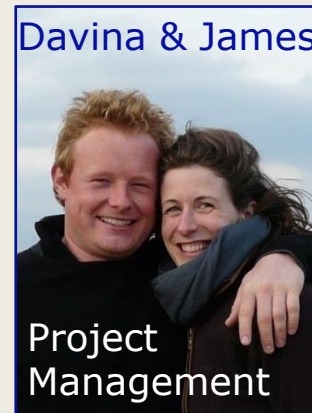
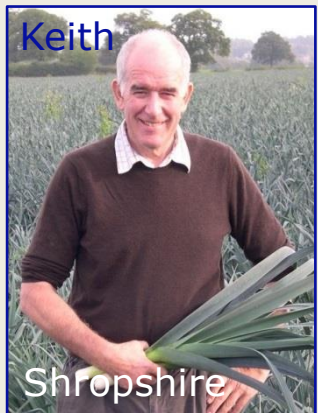

G's Fast Facts

- Established 1952
- £500m turnover
- 1 billion products
- 7,000 employees
- 19 farmers and growers in the UK
- c. 13,000 hectares
- c. £20m invested p.a.
- Supplying all major UK retailers
- Supplying major supermarkets across the EU and USA



The G's Group

- A group of marketing led family farming businesses
- Growing across 12,982 hectares in Europe and Africa



UK
5,742 ha



Spain
6,027 ha



Czech
420 ha



Senegal
425 ha



Poland
368 ha

- Dedicated to quality and service; underpinned by strong values

G's UK Growing Base

Lancashire
(Strategic Partners)
Celery

Shropshire
Spring Onions
Organic Beetroot

Warwickshire
Spring Onions
Asparagus
Legumes

Lincolnshire
Organic Veg

Norfolk
Iceberg, Romaine
Onions
Celery
Radish

Norfolk Coast
Baby Leaf
Celery
Iceberg, Romaine, Gem
Onions

Suffolk
Onions

Cambridgeshire
Celery, Fenland Celery
Iceberg, Romaine, Gem
Mushrooms
Onions
Beetroot

Kent
Spring Onions

Sussex
Iceberg
Baby Leaf
Romaine

Full Vertical Integration

Crop Establishment &
Plant Raising



Farming



Further Process
& Packing



Sales & Marketing



Crop Portfolio



Lettuce



Baby Leaf



Celery



Radish



Beetroot



Mushrooms



Onions



Garlic



Spring Onions



Brassicas



Asparagus & Legumes



Melons



Tomatoes



Citrus



Flowers

Customer Base

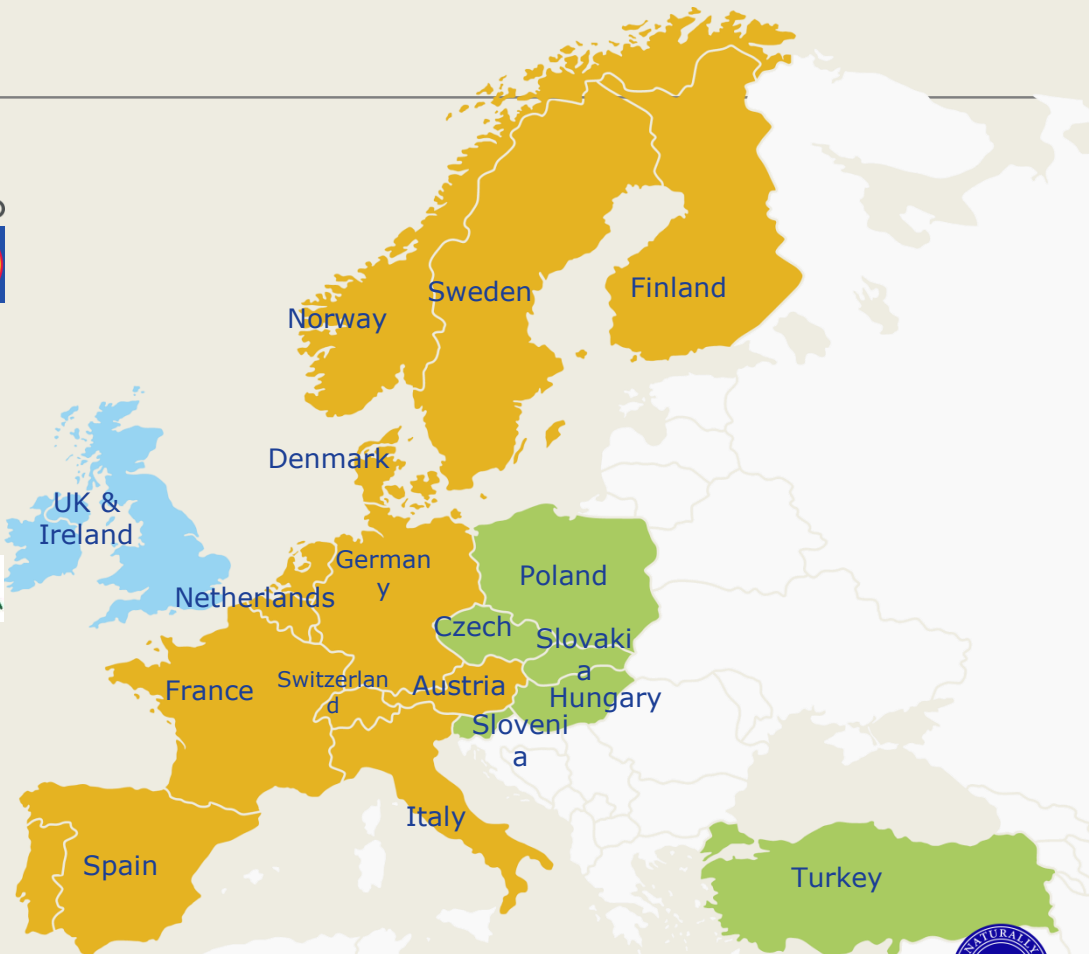

Customer Base - USA

Canada

United States

WHOLE FOODS MARKET

Kroger

Wegmans

COSTCO WHOLESALE

Ahold

Albertsons

SAFeway

Price Chopper

HyVee

shaws

Hannaford

Raley's

NOB HILL FOODS

BEL AIR

freshdirect.

BJ's

TRADER JOE'S

KINGS WHERE INSPIRATION STRIKES

ShopRite

GIANT EAGLE

TARGET

weis

Stop&Shop

King Kullen America's First Supermarket



Innovation & Investment - £215m over 10 years



Laser Land Levelling



24 Row Iceberg Planter

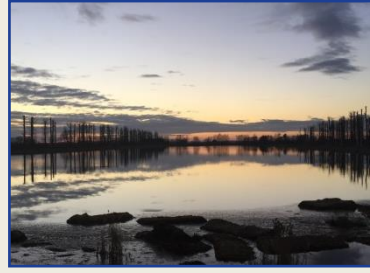

Reservoir Development



Mushroom Farm & AD Plant

Investment in the UK business is replicated in Spain & Czech



Infield Rig Packing



Plant Raising



Reservoir Development



90 ha of state-of-the-art Greenhouses



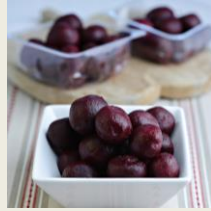

Life at G's





Our Promise, Philosophy and Values

To supply quality, fresh produce that delights our customers every day

To be recognised as outstanding market-led growers and suppliers of sustainable, healthy, fresh produce, and to be at the forefront of the industry in everything we do



Trust

Be a great place to work where openness, respect and teamwork are encouraged, in a safe, ethical environment



Efficiency

Be a highly effective, lean and fast-moving organisation from seed-to-shelf

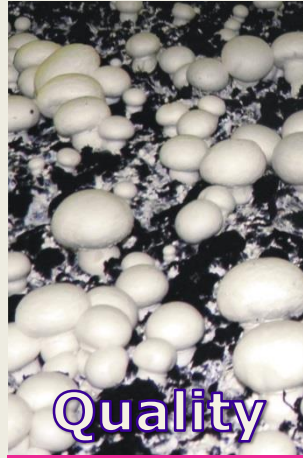

Quality

Provide outstanding quality and service to our colleagues and customers



Expertise

Be *the* experts in our field and never stop learning



Can - do

Be committed and driven in our continuous endeavour to adapt and improve

As progressive growers, we make a difference by developing our people, caring for the environment and supporting local communities



Our People



At G's we believe we have competitive advantage versus other produce companies due to our investment in:

- Facilities/Hostel
- Training & Development
- Year round employment through winter working in Spanish farms

People: Growing our own...

Local recruitment

Building school & college links

Work experience

Training & coaching

 Apprenticeships

Management Training Scheme

Good Business Sense

Good CSR Sense

Good Sustainability



Equal Opportunities Statement

G's is committed to equality and encouraging diversity amongst our workforce

Our aim is that our workforce will be truly representative of all sections of society and each worker will feel respected and able to give of their best



Ethical Trading Initiative



 <p>Employment is freely chosen</p>	 <p>Freedom of association and the right to collective bargaining are respected</p>	 <p>Working conditions are safe and hygienic</p>
 <p>Child labour shall not be used</p>	 <p>Living wages are paid</p>	 <p>Working hours are not excessive</p>
 <p>No discrimination is practised</p>	 <p>Regular employment is provided</p>	 <p>No harsh or inhumane treatment is allowed</p>

Hasse Workshop



Mechanisation & Automation Investments of £7.9m since 2012

- New More efficient harvesting rigs
- Fast speed wrapping machines
- Automation of processes- product transfers and packing, labelling
- Automated crop cutting and lifting
- Existing equipment modifications and development
- Research and development
- Dedicated design - innovation team – 3D design



Hasse Workshop Projects

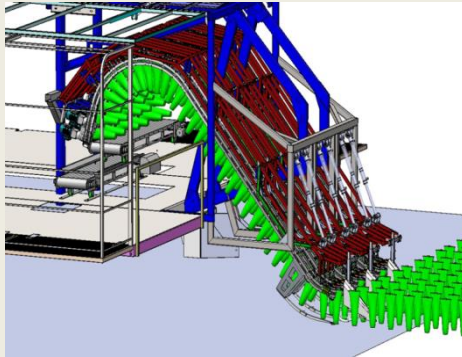
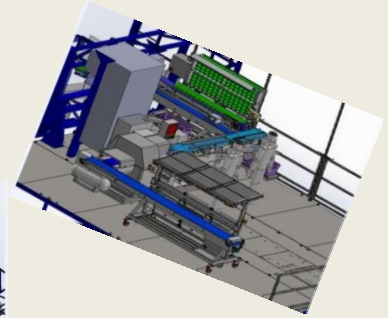
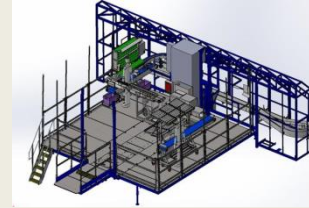
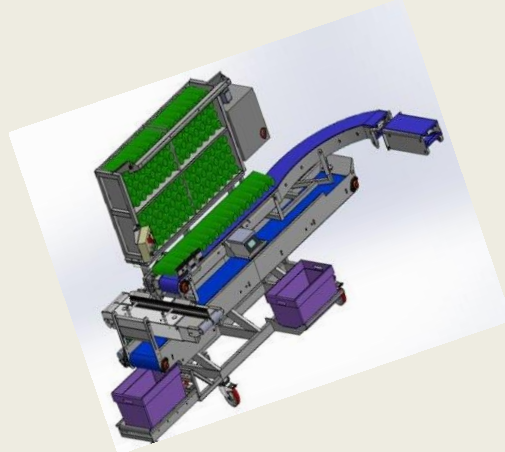
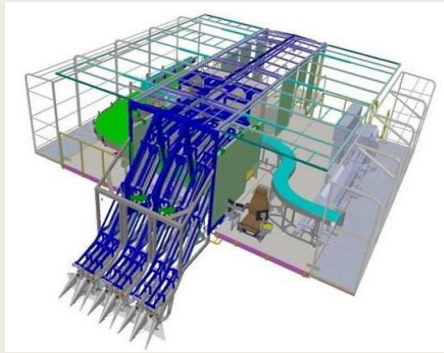

Mechanisation & Automation

- Focus on Innovation and Design through dedicated team.
- 3D design allowing to manufacture equipment in Europe at lower cost and also get accuracy at point of production.
- Working in partnership with our customers, internally and externally, to stay ahead of consumer trends, continually investing and integrating new technology throughout the fleet.

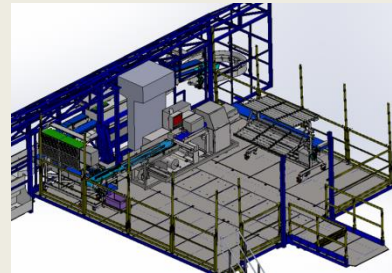







Hasse Workshop stock control system

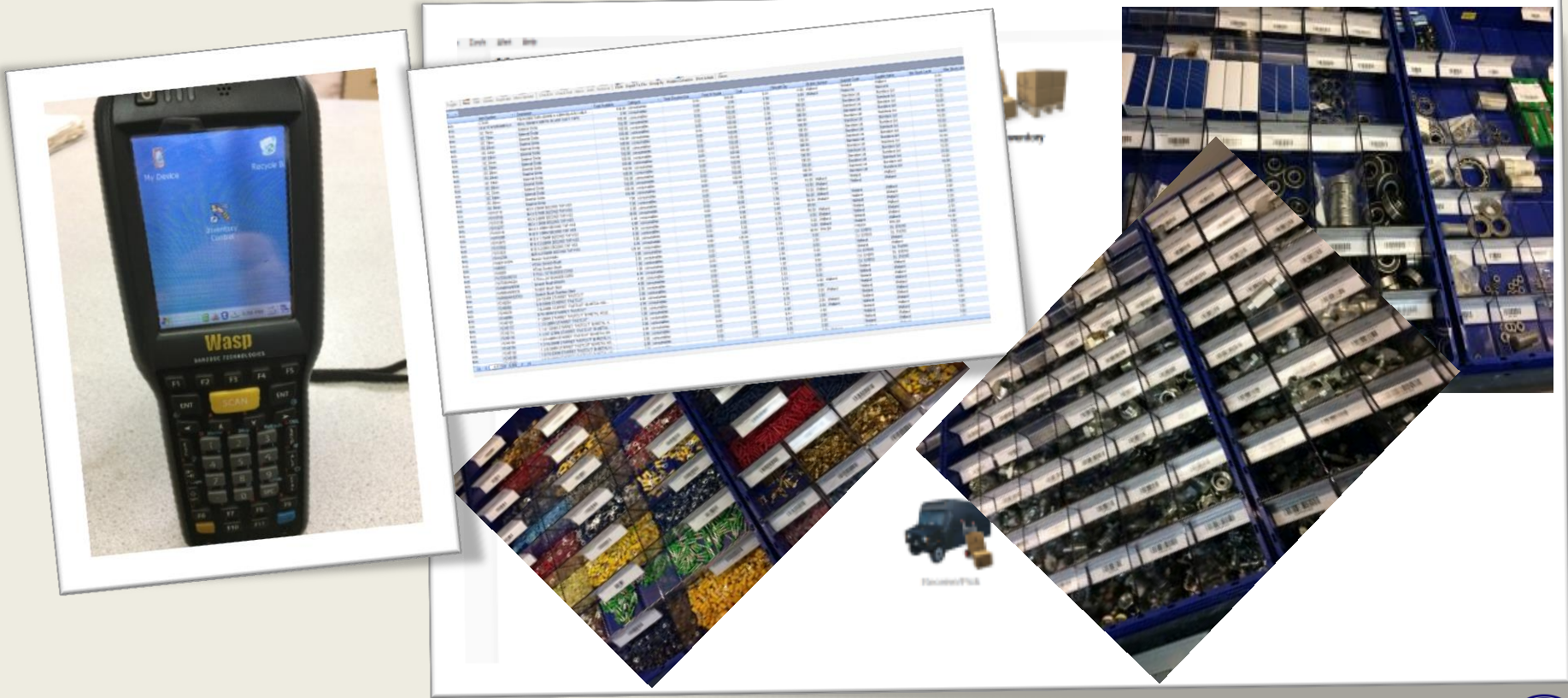

Workshop team



Winning Culture

- SHSL Thomas International team building & barbecue



Barbecue designed & built in house by the team

Students in the workshop



Students in the workshop



Contracts & Working Hours

Contracts:

- Temporary Student Engineering Operative contracts

Working Hours:

- 40 working hrs per week Monday to Friday (you may be offered voluntary overtime)
- Paid directly into your UK bank account on a weekly basis

Pay rate:

- Currently £7.83 per hour, from April 2019 - £8.21
- Currently £9.38 overtime (applicable after 40 hrs), from April 2019 - £10.26

Students tasks and learnings

- Familiarizing with Safe Working Procedures
- Learning about Preventative Maintenance
- Reactive Maintenance
- Stock control and its importance
- Welding Preparation, Welding test pieces, Inspection of test pieces, Welding equipment/Rigs
- Quality Control
- Lock off and isolation (electrical/mechanical)
- Cutting and metal preparation
- Protection and life extension of metals (Painting)
- Engine maintenance, Oil and filter change, Component inspection, specification testing (compression testing)
- Hydraulic and pneumatic system inspection and testing
- Electrical wiring inspection for damage and corrosion
- Electrical drawing (depending on student)

Accommodation



- Shared accommodation
- £52.85 per week (April 2019 onwards), bills included
- Fully equipped and operational shared kitchen/dining.
- Washing machines and tumble driers are available.
- Free Wi-Fi.
- Walking distance to the workshop.



Facilities: UK

Barway

Marketing, Production, Distribution,
Administration, Hostel

Facilities

- 5 miles radius – G's Social & Sports Centre
- Disco nights every weekend
- Summer parties
- Gym
- Access to local supermarkets



Near by

- Ely train station – 5 min drive from the Workshop
- Cambridge - 17 min by train
- London – 1 hrs by train

Places to visit in Ely:

- Ely Cathedral
- The Stained Glass Museum
- Nightlife: bars & pubs



HR Team & Contact Details



Ramona Both – HR Manager

01353 726920

ramona.both@gs-fresh.com

Liudmyla Derkach – HR Officer

01353 727409

Liudmyla.derkach@gs-fresh.com

Petar Kabasakalov – Workshop Supervisor

01353 727534

petar.kabasakalov@gs-fresh.com

Phillip Neal – Workshop Manager

01353 727599

phillip.neal@gs-fresh.com